

Sectioning Machine Accessories

Vises



811-651-144 Vise

- 2.2 in jaw opening
- 0.94 in jaw height

- 2.3 in jaw width
- 4.6 in L x 2.4 in W x 1.8 in H x
- Sized for MSX205



807-914 Cam-Lock Right Vise 807-915 Cam-Lock Left Vise

- Sized for MSX250/255

- 4 in jaw opening
- 3.5 in jaw width
- 2.375 in jaw height



811-651-203 Vise

- Rugged construction
- Screw-type vise
- Sized for MSX250/255

- 2.75 in jaw opening
- 1.00 in jaw height
- 3.00 in jaw width
- 9.6 in L x 5.25 in W x 3 in H



809-365 Vise

- Sized for MSX305/432
- In-machine vise
- 12 in L x 5 in W x 3.365 in H

- 6.5 in jaw opening
- 1.235 in jaw height
- 4 in jaw width



811-651-518 Vise

- Sized for MSX305/432
- Milling-type vise
- 14.25 in L x 8.5 in W x 4.0 in H

- 5.0 in jaw opening
- 1.5 in jaw height
- 5.5 in jaw width



811-651-520 Vise

- Sized for MSX432
- In-machine vise
- 17.0 in L x 9.0 in W x 4.75 in H

- 7.5 in jaw opening
- 1.75 in jaw height
- 6.0 in jaw width

Quick Clamp Movable Table Vises

Easily adjust to fit your sample with a flick of the wrist



809-386 Quick Clamp Movable Table Vise 809-447 Quick Clamp Table Vise

- Sized for MSX250/255

- Use with the MSX305

809-428 Quick Clamp Table Vise

- Use with the MSX432



811-651-501 Adjustable Table Vise Kit Right & Left

811-651-502 Adjustable Table Vise Left

811-651-508 Adjustable Table Vise Right

- Easily adjusts to accommodate varying sample sizes
- For use in SX-100



808-957 Clamping Fingers Kit

- Clamping fingers with two adjustable arms
- Sized for MSX250/255/305/432 T-slotted tables

809-375 Clamping Fingers Kit

- Clamping fingers with two adjustable arms
- Sized for MSX205 T-slotted tables

Sectioning Machine Accessories

Clamping Kit

Clamping Kit (p/n 807-597) includes all components shown (quantities in parenthesis). Individual components can be purchased separately.

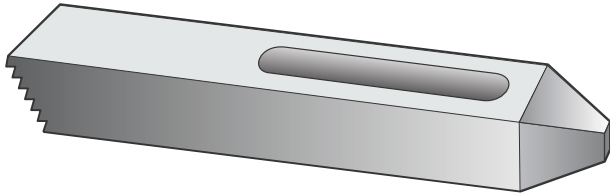

803-758 (2)
Step Clamp

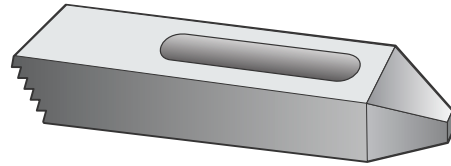

803-757 (2)
Step Clamp

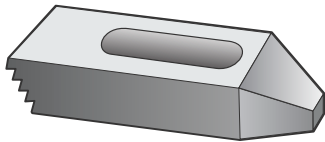

803-756 (2)
Step Clamp

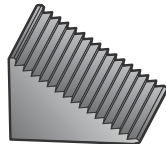

803-755 (4)
Step Block

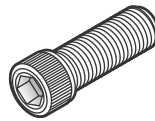

190-910 (4)
31.75 mm x 1.25"
Bolts
MSX250/255

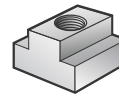

H - 13 mm
W - 22.5 mm
L - 22.5 mm

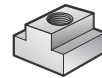

H - 10 mm
W - 13 mm
L - 13 mm

803-763 (4)
T-Slot Nuts

809-387 (4)
T-Slot Nuts for
MSX200



193-058 (4)
Flat Washer
MSX200/205



190-388 (4)
25 mm Bolt
MSX200/205

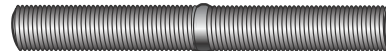

803-759 (4) Stud
(2 in./50.8 mm)

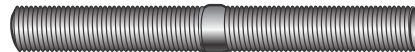

803-760 (4) Stud
(2.5 in./63.5 mm)



803-754 (4)
Hex Head Nut

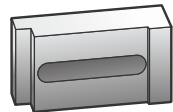

811-651-270 (2)
Clamps



803-762 (4) Stud
(4 in./101.6 mm)



803-761 (4) Stud
(3 in./76.2 mm)

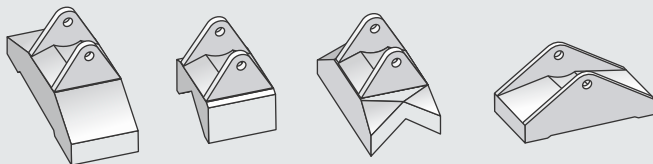

808-999
Clamping Finger Shoe Kit
(Option for 809-375 and 808-957 Clamp Fingers Kits)

Specifications and part numbers may change. Consult LECO for latest information.

3000 Lakeview Avenue | St. Joseph, MI 49085 | 800-292-6141 | Phone: 269-985-5496
info@leco.com | www.leco.com | ISO-9001:2015 Q-994 | LECO is a registered trademark of LECO Corporation.

LECO Corporation

LECO

EMPOWERING RESULTS